



Photo: davidbirri photography



HISTORIC ALPINE HOTEL GRIMSEL HOSPIZ
3864 Guttannen

www.grimselwelt.ch | events@grimselwelt.ch | +41 33 982 26 14

m
e
e
t
i
n
g
winter



Photo: davidbirri photography

Dear event organisers

The magic of the Grimselwelt can give a real lift. With the fresh mountain air come fresh ideas. Effective seminars are possible here away from the hustle and bustle of the city.

Winter at the Grimsel Hospiz is all about winding down and relaxing. Nestled deep in the snow, the historic building is a treasure in these unspoilt natural surroundings. Guests can already leave behind the stresses and strains of everyday life during their unique journey to the hotel – from an aerial cableway trip to driving through deep tunnels.

The hotel features a welcoming atmosphere, with a crackling fireplace and steaming hot tub under a magnificent starry sky awaiting guests.

We are pleased to be considered as a suitable location for your upcoming event.

Markus Meier
Hotel manager Grimselhotels

Annika Siegenthaler
Head of banquet and events

HISTORIC ALPINE HOTEL GRIMSEL HOSPIZ



Photo: davidbirri photography

General information

Address	Hotel location: Historisches Alpinhotel Grimsel Hospiz Am Grimselpass 3864 Guttannen	Meeting point and postal address: Kraftwerke Oberhasli AG / Grimselhotels Grimselstrasse 19 3862 Innertkirchen
Travel	By car If travelling from Bern or Lucerne, head towards Meiringen and further on to Innertkirchen. Head to the main building of Kraftwerke Oberhasli AG. Parking spaces are available on site. By public transport If travelling by public transport, take the train to Meiringen. Continue with the Meiringen-Innertkirchen-Bahn to the Innertkirchen Kraftwerk (Bahn) terminus. Finally, a short walk to the main building of Kraftwerke Oberhasli AG. From Innertkirchen, the journey continues in groups accompanied by a visitor guide by PostBus, cable car and underground through the power station tunnel up to the winter oasis.	
Season	Beginning of January until to the end of March.	
Notice	Please note the section winter operation in our general terms and conditions.	
Contact	Feel free to contact us if you have any questions or are unsure about anything. Please contact us in advance to arrange a tour. We'd be happy to answer your phone or email enquiries. +41 (0)33 982 26 14 events@grimselwelt.ch	

Overnight stay

The historic four-star alpine hotel sits majestically above the frozen Lake Grimsel. Behind a homely façade of rough broken granite and red shutters, you will find an interior that leaves nothing to be desired.

Our offer:

- overnight stay in a cozy room with shower/toilet, radio-TV and telephone
- generous breakfast buffet from 8.00 a.m. until 11 a.m.
- use of our hot tub & sauna
- use of the LOWA-testing-center with winter shoes
- free Wi-Fi
- services and VAT, exclusive taxes

Price per person in a double room, mountain view	from CHF 189.00
Price per person in a double room, lake view	from CHF 219.00
Price per person in a single room, mountain view	from CHF 214.00
Supplement for a double room for single use	CHF 60.00
Transportation flat rate per person	CHF 74.00

These seminar prices are valid for a minimum of 10 participants and can only be booked in combination with the conference package and at least three of the building blocks. On weekends (Friday and Saturday), during Christmas and New Year as well as for groups of less than 10 people, the regular overnight rates apply.

Hotel rooms

The hotel provides 28 rooms, designed tastefully and inspired by the 1930s. Almost all rooms offer an impressive view of the surrounding mountains.

- 2 single rooms with mountain view, shower/toilet, radio-TV and telephone
- 7 double rooms with lake view, shower/toilet, radio-TV and telephone
- 15 double rooms with mountain view, shower/toilet, radio-TV and telephone
- 4 double rooms "cinema" (no daylight), shower/toilet, radio-TV and telephone



Photo: The Photostudio



Photo: davidbirri photography



Photo: davidbirri photography

Kitchen philosophy

Roman Crkon's field, forest and meadow cuisine is a real labour of love! With 15 Gault Millau points, his kitchen is a feast for all the senses. Here, he offers guests a genuine and authentic culinary experience

Exclusivity - Rent a hotel

Are you interested in an exclusive rental of the Historic Alpine Hotel Grimsel Hospiz?
Do not hesitate to contact us.

Meeting rooms

Turmsaal

Whether a seminar, written examination or workshop, the Turmsaal is the perfect place for hosting your event.



Photo: davidbirri photography

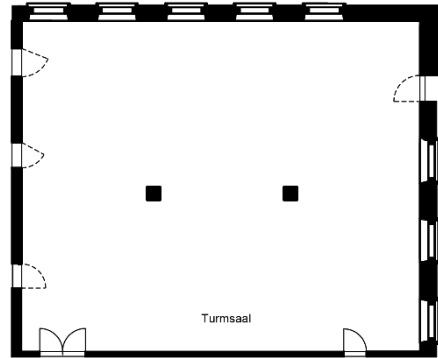

height	wide	length	m2	block seating	U-shaped seating	seminar seating	cinema seating
2.7	11.9	14.2	170	48	36	30	150

Pionierzimmer

The Pionierzimmer is ideal for face-to-face discussions, small-scale meetings or additional group work.



Photo: davidbirri photography

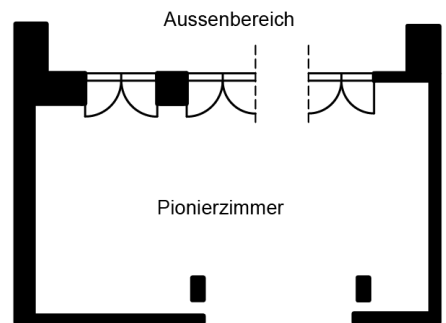

height	wide	length	m2	block seating	U-shaped seating	seminar seating	cinema seating
2.3	3.4	8.4	29	12	-	-	-

Bergsteigerstübli

The Bergsteigerstübli can be used for short discussions or as an additional room for group work.



Photo: The Photostudio

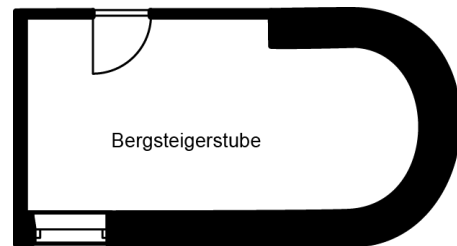

height	wide	length	m2	block seating	U-shaped seating	seminar seating	cinema seating
2.5	3.0	7.0	21	12	-	-	-

CONFERENCE PACKAGE

The daily flat rate is charged as the basis for your seminar day. The flat rate includes the following:

- room rental for the plenary
- technical equipment
 - projector and screen or TV
 - pin board, flip chart and presenter's case
 - free Wi-Fi
 - notepad and ballpoint pen
- Grimsel water (sparkling and non-sparkling)
- fruit basket and cereal bars

Price per person CHF 37.00

For less than 10 participants we charge an additional fee of CHF 5.00 per person and per day.

BUILDING BLOCKS FOR YOUR CONFERENCE PACKAGE

You can add the following components to the conference package to customise your meeting.

Welcome coffee

Would you like a welcome coffee at your arrival?

- coffee, espresso and variation of fruit and herb teas
- Grimsel water (sparkling and non-sparkling)
- croissants (1 piece per person)

Price per person CHF 8.50

Coffee break

For a refreshment in between, we recommend our coffee break served with small snacks.

- coffee, espresso and variation of fruit and herb teas
- various fruit juices
- Grimsel water (sparkling and non-sparkling)
- sweet or salty appetizers

Price per person CHF 16.00

Business lunch

At lunchtime, we serve a 3-course business lunch, a seasonal creation from our kitchen:

Price per person CHF 47.00

Gourmet menu

Let us spoil you with our 4-, 5- or 6-course gourmet menu for dinner.

Price per person for 4-course CHF 91.00

Price per person for 5-course CHF 102.00

Price per person for 6-course CHF 117.00

Upon request, we will recommend a delicious aperitif.



Photo: davidbirri photography



Photo: plpictures by Paedii Luchs



Photo: Gramarts by Marc Lüthi



Photo: The Photostudio



Photo: davidbirri photography

ADVENTUROUS ARRIVAL AND DEPARTURE

In winter, your arrival at Grimsel Hospiz is that little bit out of the ordinary. Switzerland's most remote four-star hotel is only accessible when accompanied by one of our personal guides.



We meet at the arranged time at the headquarters of Kraftwerke Oberhasli AG in Innertkirchen, before setting off together on the trip up to the Grimsel Hospiz.

Your trip with the PostBus from Innertkirchen to the Handeck power plants is organised and reserved for you. The journey continues via aerial cableway to Gerstenegg, then underground through the tunnel leading to the Grimsel 1 power plant. The Hospizbahn then takes you on the final bit up to your destination, the Grimsel Hospiz.

Here, a world far away from the hustle and bustle of everyday life awaits you.

We recommend sturdy footwear, winter clothing and light luggage for your arrival and departure. The path is not accessible by wheelchair or to the disabled. Do not forget your swimsuit for a dip in our wooden hot tub and sun cream for when the sun shines here in the Grimselwelt.



Photo: Nicolas Glauser

WILDLIFE RESERVE

The Grimsel Hospiz is located in a wildlife reserve and is not suitable as a stop on a ski tour. This oasis of calm for both man and animal should be maintained. For safety reasons, the marked perimeter on the Nollen rock spur at Grimsel Hospiz should not be crossed.

In order to protect the wildlife, winter sports equipment is not transported on the railways leading to Grimsel Hospiz. It is also not permitted at the hotel.

SUPPORTING PROGRAM IN THE WINTER OASIS

At the winter oasis, the only option is to relax and kick back in exclusive surroundings.

Eternal ice is a fascinating prospect for young and old alike. Enjoy a short hike in the alpine mountain landscape, through the depths of winter or we are also on hand to tell you everything there is to know on the topic of electricity, travelling through the twisting underground labyrinth at the Oberhasli power plants and exploring a crystal grotto that is millions of years old.

Winter hiking trail

The winter hiking trail is the perfect way of exploring the fairytale winter landscape on snow shoes. The shortest winter hiking trail in the Bernese Oberland runs once around the hotel. The clearly signposted hiking trail then leads upwards into the high-alpine area. Here in the wildlife reserve, it is immediately clear why this area is under special protection.

Power plant tour

The Grimselwelt's power plants are power plants you can get close to. Deep inside the mountains, everything is all action. The turbines at the power plants at Kraftwerke Oberhasli AG run at full power – year in, year out. Experience the energy hidden in the granite and check out the fascinating crystal grotto.

We would be happy to put together a personal program for your trip to the Grimselwelt – please get in touch with us. The program and detailed booking documents will be sent to you directly.

Additional information about our offers and activities can be found on our website www.grimselwelt.ch.



Photo: Nicolas Glauser

CONDITIONS

Please note that our general terms and conditions are an integrated part of all our offers and confirmations.



WE LOOK FORWARD TO SEEING YOU!

GRIMSELWELT

Grimselstrasse 19
CH-3862 Innertkirchen
welcome@grimselwelt.ch
www.grimselwelt.ch

GRIMSELHOTELS

hotels@grimselwelt.ch

Handeck

Hotel und Naturresort
CH-3864 Guttannen
Tel +41 33 982 36 11

Grimsel Hospiz

Historisches Alpinhotel
CH-3864 Guttannen
Tel +41 33 982 46 11

Oberaar

Restaurant und Berghaus
CH-3864 Guttannen
Tel +41 33 982 48 11

Bäregg

Ferien- und Alpinhütte
CH-3864 Guttannen
Tel +41 33 982 36 11

